

DEPARTMENT OF BUSINESS AND MANAGEMENT

Department meeting – MINUTES 21 May 2024

1. Welcome & Congratulations

New employees

Kristoffer Balslev Willert, postdoc, Ci2M / CCC (PACA)

Funding

Title: A Double-Edged Sword: Examining the Impact of Bonus Transparency on Supervisor Differentiation Practices

Grant: Fynske Købstæders Fond

Amount: 29.850 DKK

Grantee: **Razvan Ghita**, Accounting

Title: Communication Outside Experimental Design: Comparing Labs and Crowdsourcing Platforms.

Grant: Fynske Købstæders Fond

Amount: 29.850 DKK

Grantee: **Razvan Ghita**, Accounting

Title: On Reducing the Weight of Luck in Discretionary Evaluations

Grant: Fynske Købstæders Fond

Amount: 46.000 DKK

Grantee: **Razvan Ghita**, Accounting

Title: Incorporating Observable Luck into Discretionary Evaluations: Employee and Supervisor Perspectives

Grant: Fynske Købstæders Fond

Amount: 27.480 DKK

Grantee: **Razvan Ghita**, Accounting

Title: NGR II Droner - NextGen - Robotics

Grant: P1 - Innovation, konkurrenceevne og digitalisering - EU - Struktur fonden (European Structural and Investment Funds (ESI))

Amount: 671.000 DKK

Grantee: **Mette Præst Knudsen**, Ci2M

Title: European Naturecultures: optimizing monitoring and management of agricultural/wildlife contact zones

Grant: EUopSTART - Uddannelses- og Forskningsministeriet - UFM

Amount: 75.000 DKK

Grantee: **Julie Emontspool**, CCC

DEPARTMENT OF BUSINESS AND MANAGEMENT

Publications from 27 January to 15 May 2024

See enclosure

Events

DBM hosted the SDU Business School Days in Odense from 4 to 15 March 2024 successfully. 29 students participated in the business challenge case with Deloitte. 22 companies took part in the career fair.

2. Meet Hanne Søndergaard Birkmose, interim dean

Until August 1 Hanne will be interim dean. Her main task is to keep focus on AACSB and the strategy to secure a good and healthy faculty.

3. EU Funding by Research Support - Laura Landorff, Susanne Feldt Jørgensen, Frederikke Korsgaard Bork

Susanne presented SDU's funding strategy (2023-2030)– <https://sdunet.dk/en/research/funding-strategy>

Focus is on private Danish Foundations, Centers of Excellence and EU funding.

Four strategic focus areas:

- Recruitment and Talent development
- Prioritization and management
- Organisation and administrative support
- Networking – internally & externally

Find the presentation as enclosure and read more about the initiatives, as well as the application process and collaboration with RSO.

European Days at BSS

23rd May – European Funding online meeting

18th June (Kolding) and 20th June (Odense) workshop – visible in Europe, pitch your ideas.

For news and contact information read more here <https://sdunet.dk/en/research>

4. DBM News

DBM Economy

Dannie gave an overview of the financial situation at the department. It is expected that the department will end with a deficit this year, and a deficit is also expected in 2025. Hereafter, there is a positive trend, even though we cannot foresee what will happen as we still await the reform of the cand. merc. and there will also be a reduction of bachelor students.

DEPARTMENT OF BUSINESS AND MANAGEMENT

Dannie explained that the income level in the budget is based on projections with a delay of 1.5 year.

Dannie reminded everyone to hand in timesheets for projects, to be able to use the grants according to the project budgets. We also would like to avoid sending back any grants we have not used.

External funding plays and will play an important part of the DBM economy.

AACBS

- Research assistants to be teamed up with researchers as AACSB requires that teaching is conducted with employees with research backgrounds.
- In June 2025 the AACSB peer review will visit us and will focus on those areas they found problematic at the latest meeting.

Lifelong Learning

- Marianne Harbo Frederiksen is part of the faculty's Task Force on how to develop lifelong learning. With the reform of cand. merc, this work is very important.
- SDU management has decided to close SDUx in Vejle. SDUx was an experiment in developing new forms for lifelong learning in collaboration with industries.

Areas of thought leadership

- 17 June – inspiration day from 10-12. The first hour will be a faculty event online followed by a one hour departmental activity event also online. There will be a follow up at the August seminar.

5. HA reform update by Tina Lundø Tranekjer

Transferring the old HA reform to a new one involved establishment of two committees, the practice committee and innovation committee. Tina thanked everyone involved.

Tina headed the Practice Committee and the two committees had a joint meeting a few weeks back where the findings were presented to the Business School Management.

From April to August – discussions and final development of a new HA curriculum is to be developed. Tina is also part of this team together with Mette Lund Kristensen and Hans Frimor from IVI + malene Damsted and Mette Søgaard Nielsen from IEB.

Outstanding things discussed: which criteria are the new HA reform to be built upon and some criteria are fixed by the faculty. Change of content or should HA look like it is and if we change a lot we will have to apply for a new accreditation. Two departments now own HA (the Business School) instead of four departments.

6. News from the library by Jette Jorsal – email: jejo@bib.sdu.dk / phone: 6550 2645

• Scite.ai

The library has purchased a license for the AI tool 'Scite.ai', which can be used for literature and/or information searches.

<https://proxy1-bib.sdu.dk/login?url=https://scite.ai/>

DEPARTMENT OF BUSINESS AND MANAGEMENT

- AI added to the guide for Copyright rules for lecturers at SDU
<https://libguides.sdu.dk/copyright>

7. **Emergency Procedure** by your work environment group

See enclosure.

Everyone should occasionally remind themselves of the evacuation procedures; what to do in case of an emergency and possible evacuation. Please learn more [here](#)

Gitte informed that in June the election for a new work environment represent will be initiated. In case you have questions for the role, please feel free to contact Gitte.

Emergency Procedures

SDU



University of Southern Denmark
Business School

Overview maps for all campuses:

<https://sdunet.dk/en/servicesider/beredskab-paa-sdu/overordnede-oversigtskort>

**FOR DIN SIKKERHED /
FOR YOUR SAFETY**

- Safety point:**
- Hjertestarter /
Defibrillator
- Elevator til bære /
Elevator for stretchers
- Adgang for politi og ambulance /
Access for emergency services
- Samleplads /
Assembly point

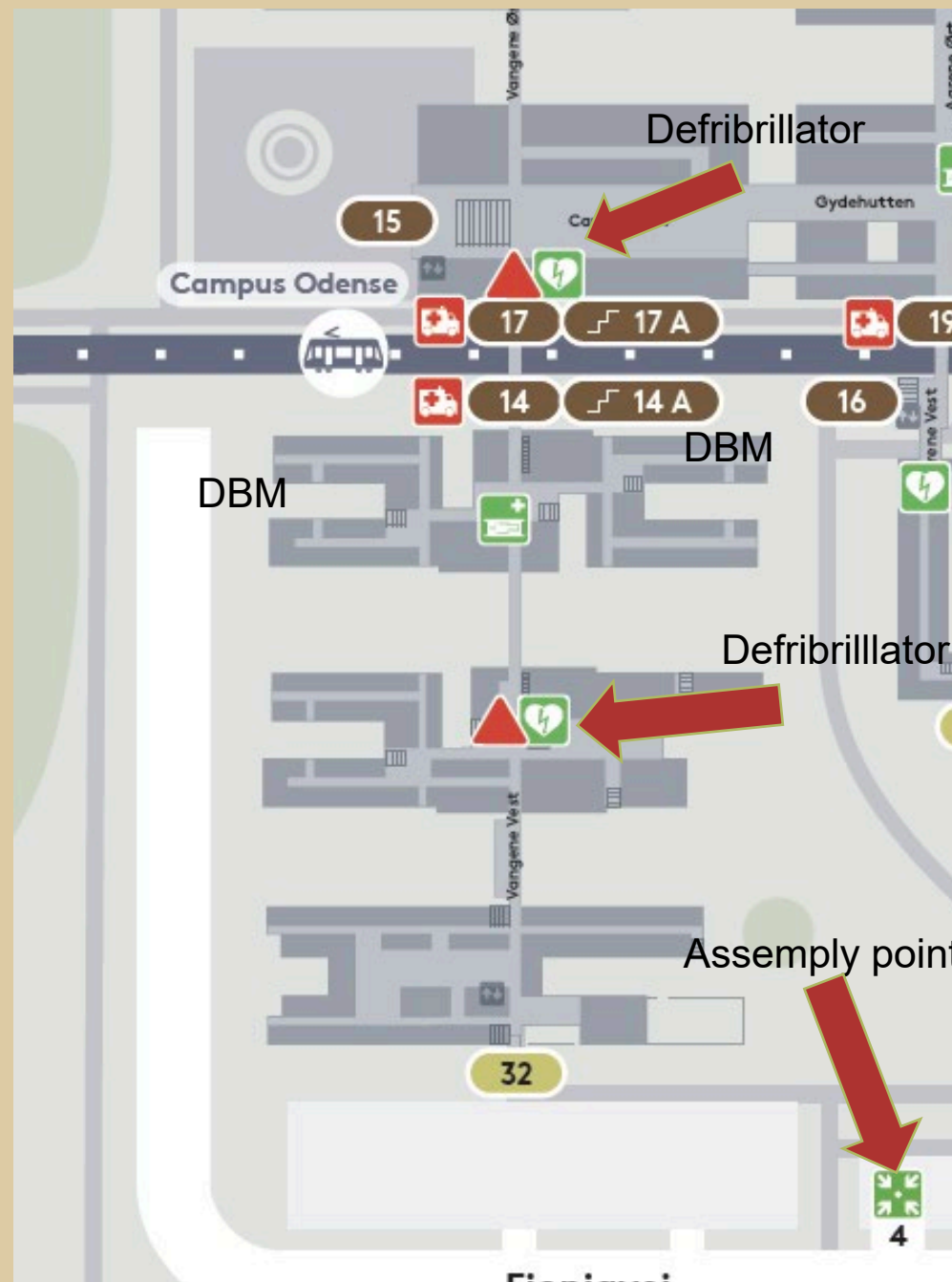

Evacuation types

Building 34.4 where Adm, SOD, CCC, IBE + FIN, ACCT:

Automatic fire alarm with speaking connecting automatically to the firefighting service + sprinkler system

Pavillion 2, Ci2M:

No automatic fire alarm, call out on all floors

Slagelse Map:

Only automatic fire alarm in teaching areas, call out on all floors

Kolding:

Automatic fire alarm with speaking connecting automatically to the firefighting service + sprinkler system

Safety Points

- Overview map indicating the ambulance route and escape route, emergency equipment (e.g. fire extinguisher, defibrillator, first aid kit)

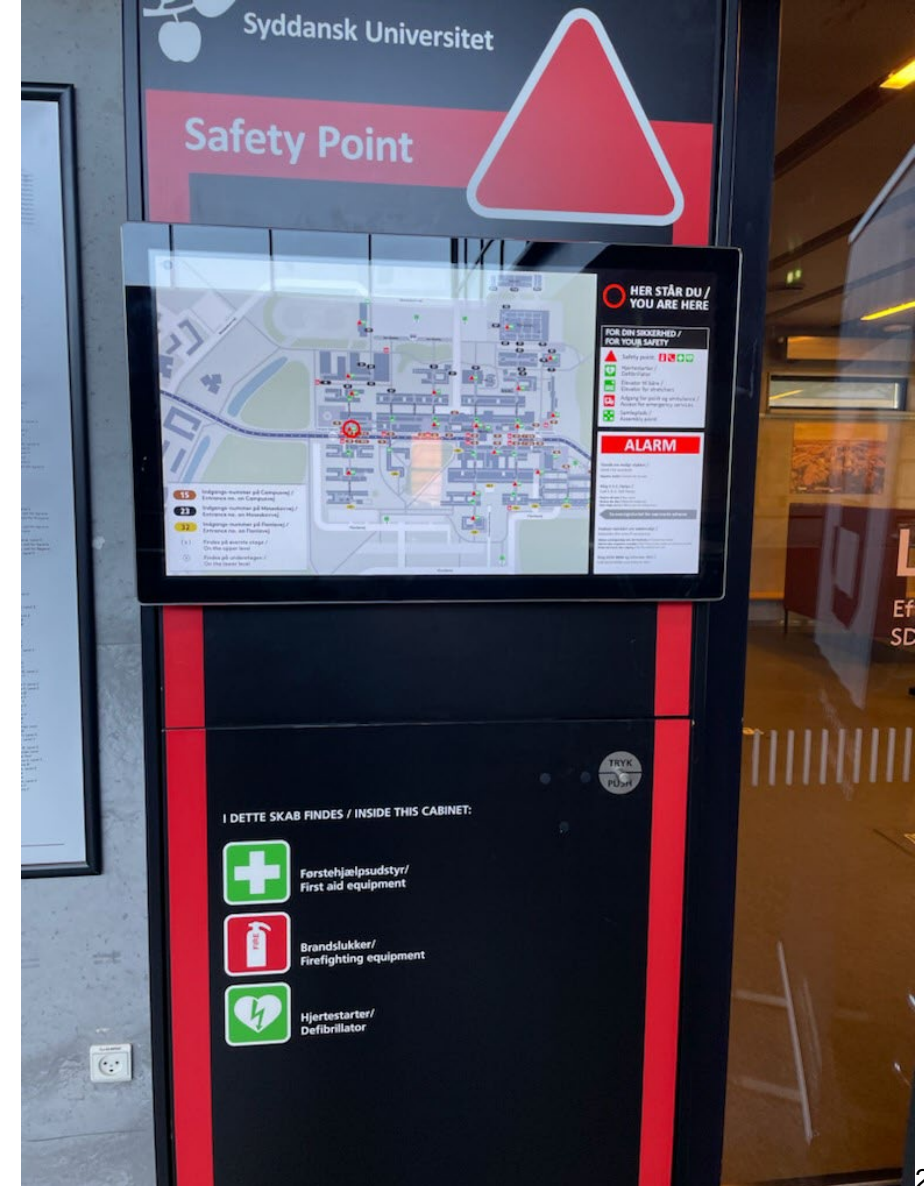
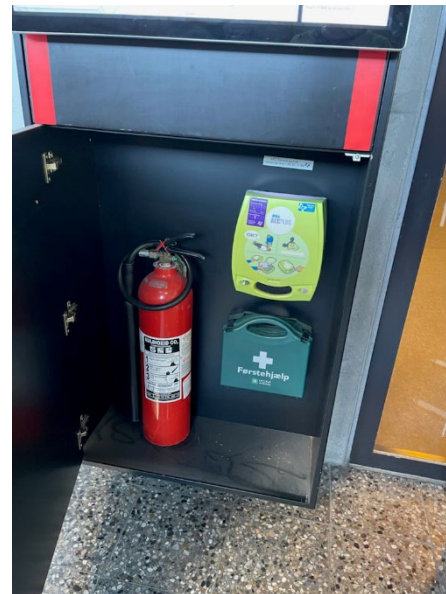

Emergency Procedure on SDU

- Evacuation Stand with evacuation equipment
- The evacuation leader (Yellow jacket)
 - Make sure people leave the building
 - Give the assembly point manager a status report at the assembly point.
- The assembly point leader (Orange jacket)
 - Overall responsibility for establishing the assembly point for evacuees
 - Inform about result of the evacuation to the police/fire service and for reporting back to evacuees

<https://sdunet.dk/en/servicesider/beredskab-paa-sdu>



Local emergency procedure

https://sdunet.dk/en/enheder/institutter/ivl/personaleforhold_og_arbejdsmiljoe/arbejdsmiljoe/emergency-procedure

SDU emergency procedure

<https://sdunet.dk/en/servicesider/beredskab-paa-sdu>



**Business beyond
the obvious.**