

# Remote desktop to SDU servers

Fill in as shown below, press OK in the settings window and press connect.

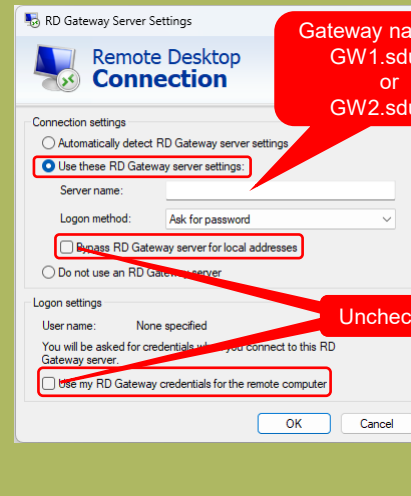
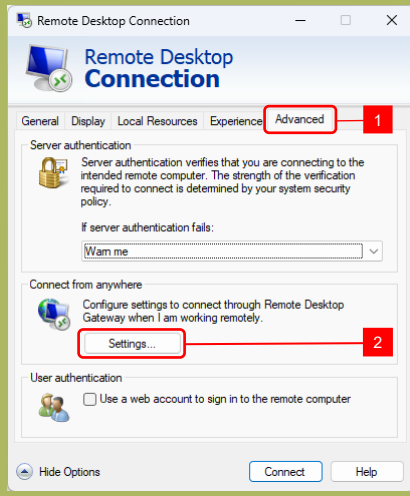
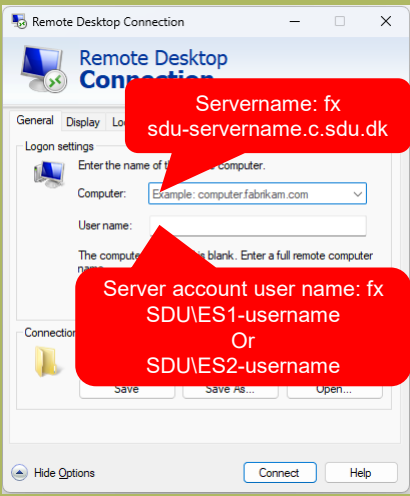

\* find gateway name for your account in the table below

User account	Gateway name
WS0-username	GW0.sdu.dk
WS1-username	
IU1-username	GW1.sdu.dk
ES1-username	
WS2-username	
IU2-username	GW2.sdu.dk
ES2-username	
WS3-username	GW3.sdu.dk

Fill in Gateway credentials, press OK and approve on mobil phone Authenticator app. Then fill in the server credentials for the server account and press OK.

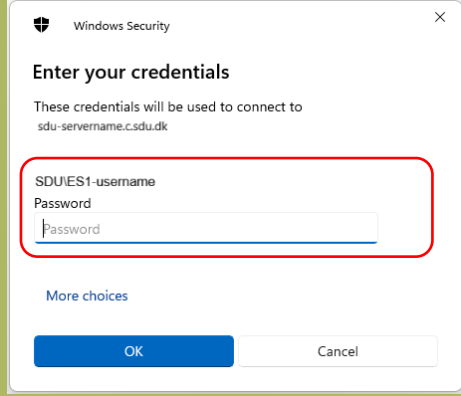
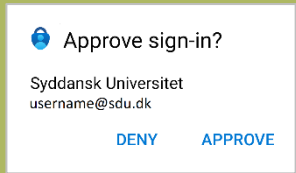
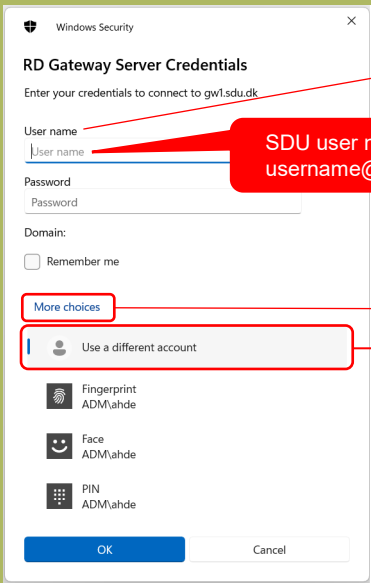

**Note!** Only User name is allowed. PIN, Fingerprint, Face and the “Remember me” option are not supported.

**Note!** (link til vejledning af mfa- og VPN-setup)  
Microsoft Authenticator app on mobil phone required.  
[aka.ms/mfasetup](https://aka.ms/mfasetup)

*VPN connection to SDU is required to access resources*

# Filesharing with SDU servers

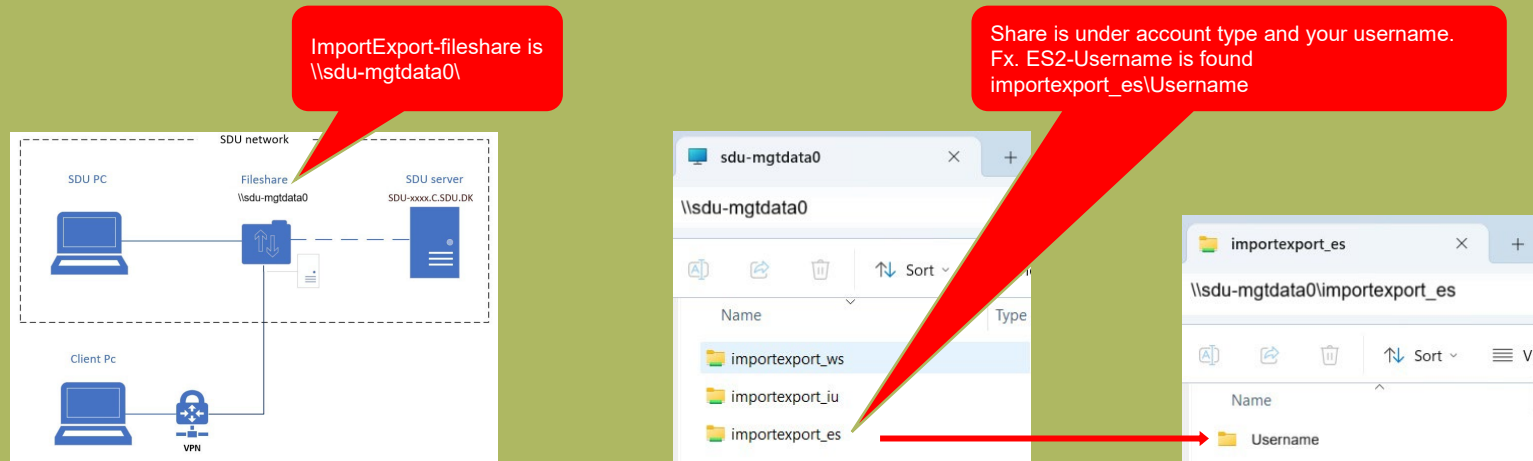

## Method for importing files on SDU-server

1. Download on your PC
2. Copy to SDU-share from PC
3. Copy to SDU-server from SDU-share
4. Unblock file from properties

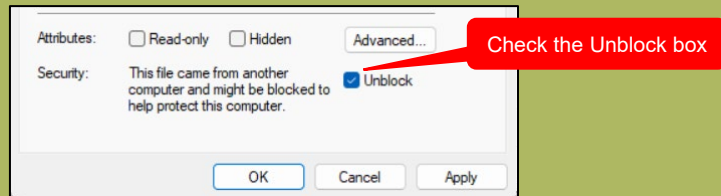

**!NB Share content is deleted every week.  
Share is only intended for importing/exporting files**